

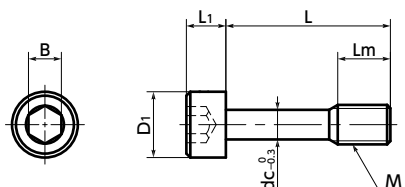

SSC Socket Head Cap Captive Screws

SUS Stainless steel



Material/Finish



	SSC
Main Body	SUSXM7 (Equivalent to SUS304)
Strength Class	A2-70

⚠ Precautions for Use

- Screw hole inner diameter on the cover side shall be at least the dc dimension.
- The cover thickness should be 0.8 mm or above.

• Installation example

Process a screw hole in the cover, then pass **SSC** thread through it. Even when the screw is removed from the frame, **SSC** does not fall out from the cover because **SSC** thread catches on the screw hole of the cover.

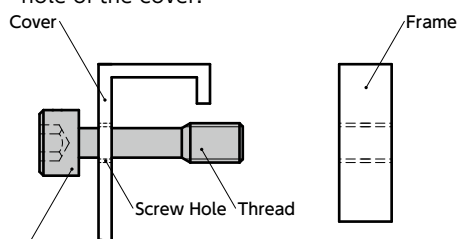

SSC Socket Head Cap Captive Screw



- The shape of the screws prevent them from falling out and loss. For fixing protective and inspection covers that are frequently installed and removed.
- Socket head cap screw type.
- These items comply with CE marking requirements.
→ P.xxxx
- Also, captive screws with special specifications for dimensions, shapes, materials, and surface treatments are available.



• Application

Securement of protective and inspection covers and compliance with CE marked products
Machine tools, food industry machines, and electrical and electronic equipment

Unit : mm

Part Number	M (Coarse)		L									Lm	D1	L1	B	dc	Mass (g)
	Nominal of Thread	Pitch															
SSC-M3	M3	0.5	8	10	12	16					4	5.5	3	2.5	2.2	0.8 - 1.2	
SSC-M4	M4	0.7		10	12	16	20				5	7	4	3	3	1.8 - 2.7	
SSC-M5	M5	0.8			12	16	20	25			6	8.5	5	4	3.9	3 - 4.8	
SSC-M6	M6	1			12	16	20	25	30		8	10	6	5	4.5	5.1 - 8.3	
SSC-M8	M8	1.25				16	20	25	30	35	40	10	13	8	6	6.3	12 - 21

• Part number specification

SSC-M6-12



1 Individual Sales → P.xxxx	Cleanroom Wash & Packaging → P.xxxx	Screw Length Adjustment → P.xxxx	Vibration Resistant → P.xxxx	Modification process for captive use → P.xxxx
1 piece in 1 pack	Available / Add'l charge	Not Available	Not Available	with Captive Processing