

LYSC-N

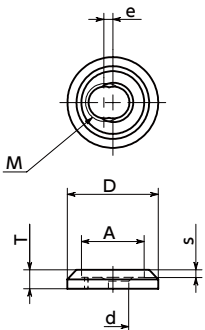

SSC

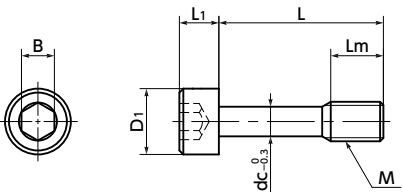

LYSC-N-SSC



LYSC-N

- With a pull mounted on it, the pull mounting surface is beautifully decorated while falling of screws within the enclosure is prevented.
- No additional modification of cover or door is required to mount the pull.
- For applications such as food machinery, packing machinery and chemical manufacturing devices that require countermeasures against parts falling.
- A captive screw for mounting **SSC** is supplied.

• Material/Finish



	LYSC-N-SSC
Captive Washer for Pulls LYSC-N	SUS304 Barrel Polishing
Captive Screw SSC	SUSXM7 (Equivalent to SUS304)

Part Number	Captive Washer for Pull LYSC-N							Captive Screw SSC							Mass (g)
	D	M	d	e	A	T	s	M	L	Lm	D1	L1	B	dc	
LYSC-12-N-SSC-M5-12	12	M5	4.2	1.2	8.3	2.5	1	M5	12	6	8.5	5	4	3.9	4.4
LYSC-12-N-SSC-M5-16	12	M5	4.2	1.2	8.3	2.5	1	M5	16	6	8.5	5	4	3.9	4.9
LYSC-16A-N-SSC-M5-12	16	M5	4.2	1.5	10.3	3	1.5	M5	12	6	8.5	5	4	3.9	6.1
LYSC-16A-N-SSC-M5-16	16	M5	4.2	1.5	10.3	3	1.5	M5	16	6	8.5	5	4	3.9	6.6

Unit : mm

• Part number specification

LYSC-12-N-SSC-M5-12



• Installation Method

- ① Let the supplied captive screw **SSC** through the cover and door and tighten it into the screw hole located in the position eccentric from the center of the captive washer for the pull **LYSC-N** from the pull mounting surface until the cylindrical part of **SSC** is penetrated **Figure 2**.
- ② Move **SSC** to the drilled hole at the center of **LYSC-N** **Figure 3**.
- ③ In the state indicated in **Figure 3**, tighten **SSC** to mount the pull **Figure 4**.
- ④ After mounting, the pull screw hole and **SSC** are retained at the center of **LYSC-N**. At this point, the drilled hole at the center of **LYSC-N** is smaller than the screw part of **SSC**, so **SSC** never comes out of the drilled hole and falling is prevented.

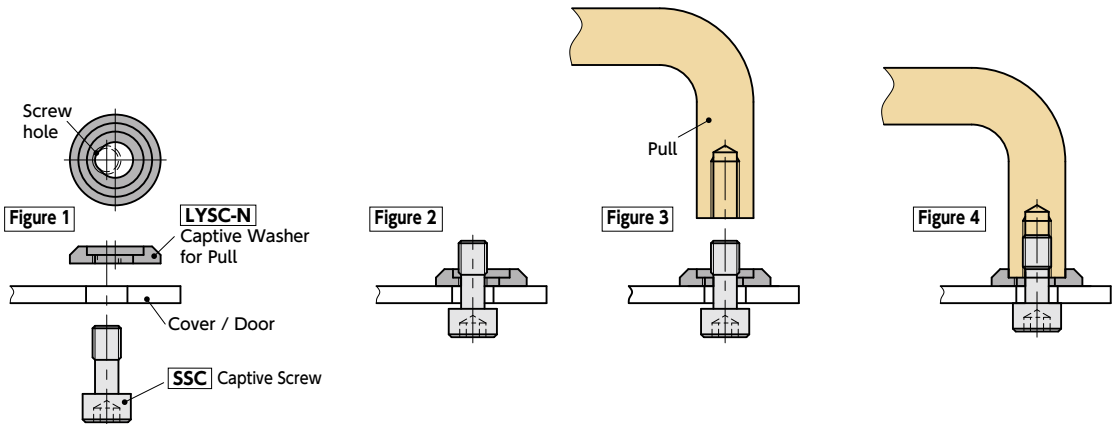

• Applicable Pulls

Part Number	Applicable Pulls			
	UNF	UNFS	UNFA	TG
LYSC-12-N-SSC				TG-108 TG-128
LYSC-16A-N-SSC	All Sizes		All Sizes	TG-110 TG-130