

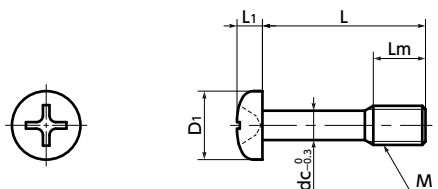

SSCPS

Cross Recessed Pan Head Captive Machine Screws

SUS Stainless steel



● Installation example

Make a screw hole in the cover, then pass **SSCPS** thread through it. Even when the screw is removed from the frame, **SSCPS** does not fall out from the cover because **SSCPS** thread catches on the screw hole of the cover.

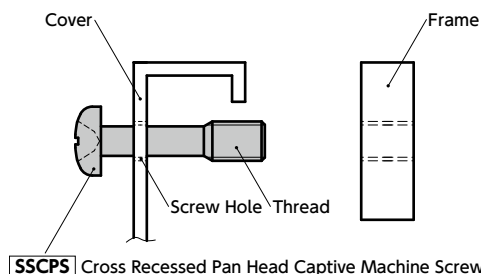

- The shape of the screws prevent them from falling out and loss. They are intended to fix protective and inspection covers that are frequently installed and removed.
- Cross Recessed pan head machine screws.
- These items comply with CE marking requirements.
- Application

Securement of protective and inspection covers and compliance with CE marked products.

Machine tools, food industry machines, and electrical and electronic equipment

● Material/Finish





	SSCPS
Main Body	SUSXM7 (Equivalent to SUS304)
Strength Class	A2-50

⚠ Precautions for Use

- The inner diameter of the screw hole of the cover must be equal or larger than dimension dc.
- The thickness of the cover must be 0.8 mm or more.

Unit : mm

Part Number 	M (Coarse)		L 								Lm	D1	L1	dc	Cross-recessed Socket Number	Mass (g)	
	Nominal of Thread	Pitch															
SSCPS-M3	M3	0.5	8	10	12	16					4	5.5	2	2.2	2	0.61 - 0.94	
SSCPS-M4	M4	0.7		10	12	16	20				5	7	2.6	3	2	1.3 - 2.1	
SSCPS-M5	M5	0.8			12	16	20	25			6	9	3.3	3.9	2	2.7 - 4.2	
SSCPS-M6	M6	1			12	16	20	25	30		8	10.5	3.9	4.6	3	4.3 - 7.4	
SSCPS-M8	M8	1.25				16	20	25	30	35	40	10	14	5.2	6.3	3	10 - 18

● Part number specification

SSCPS-M6-12

1
2

1 Individual Sales	Cleanroom Wash & Packaging	Screw Length Adjustment	Vibration Resistant	Modification process for captive use
1 piece in 1 pack	Available / Add'l charge	Not Available	Not Available	with Captive Processing