

# DFS-N-H Angle Hinge - Hex Nut Retention

 wall/panel Mount

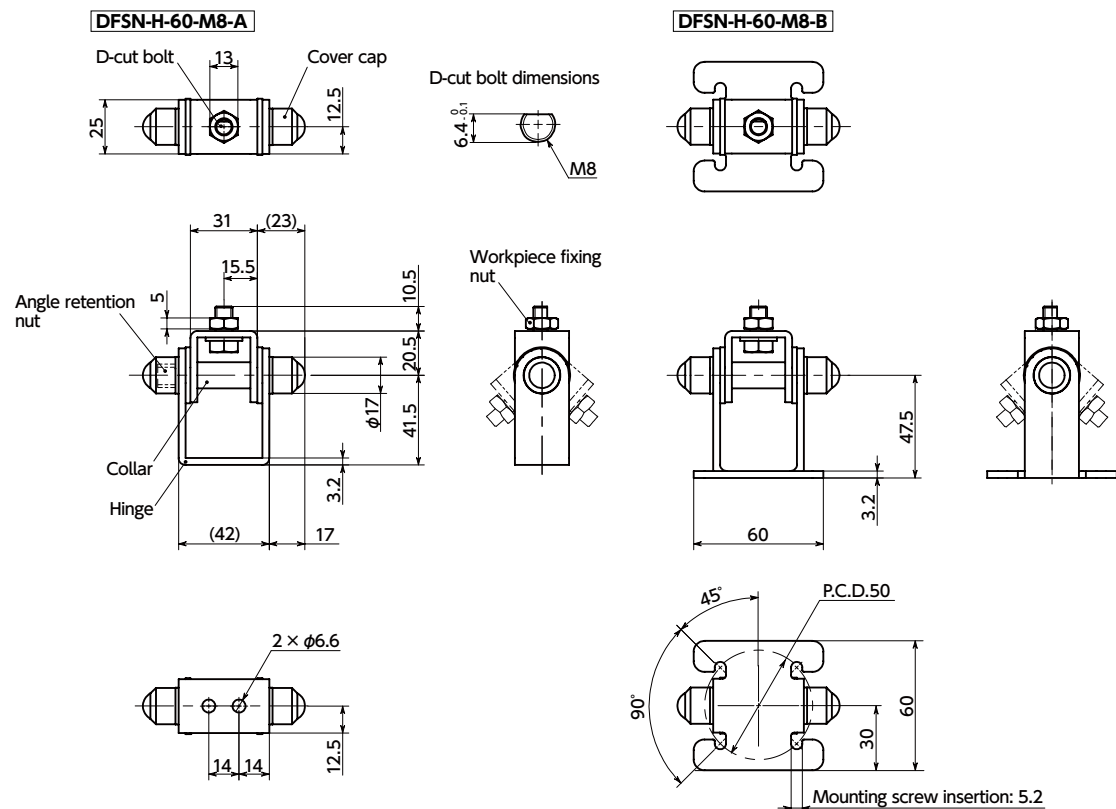

## Material/Finish

	DFS-N-H
Hinge	SPCC Electrostatic Coating (black)
Angle Retention Nut	S45C Trivalent Chromate Treatment
D-cut Bolt	SUS304
Workpiece Fixing Nut	SUS304
Cover Cap	Polyethylene (Black)
Collar	SPCC Trivalent Chromate Treatment

Part Number	Nominal of Mounting Thread*1	Max. Load Weight (kg)	Mass (g)
DFS-N-H-60-M8-A	M6	10	199
DFS-N-H-60-M8-B	M5	10	254

\*1: For mounting to the **DFS-N-H** device, use the hex socket head cap screws. Mounting bolts are not supplied.

## Related Products

Parts can be used in combination.

For Aluminum Frame End Surface Mounting Bracket **DAA**

Mounting Plate **DAF**

For Round Pipe Bracket **DPB**



- You can adjust the angle of the workpiece mounted to the D-cut bolt.
- Tightening the angle retention nut will retain the angle after adjustment.
- You can combine the display mounting system **DFR** (→ P.xxx) with the D-cut bolt, to mount the display or various workpieces.
- Because the aluminum frame end surface mounting bracket **DAA** (→ P.xxx), mounting plate **DAF** (→ P.xxx), and for round pipe bracket **DPB** (→ P.xxx) have compatible mounting dimensions, you can combine them for use, as is, without any processing.

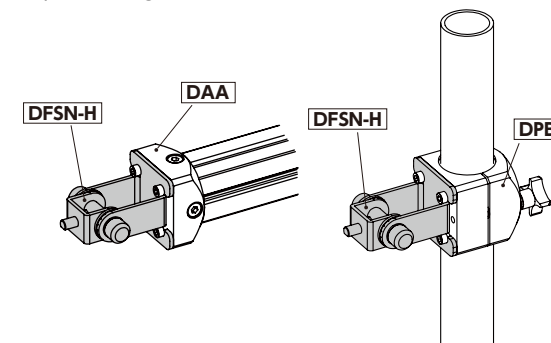

## Application

Machine tool / Medical equipment / FPD production device / Semiconductor manufacturing device / Packing machine / Food machinery

## Installation Method

Mount the workpiece to a D-cut bolt, and fix it in place with a workpiece fixing nut. For mounting to the device, use a hex head mounting bolt.

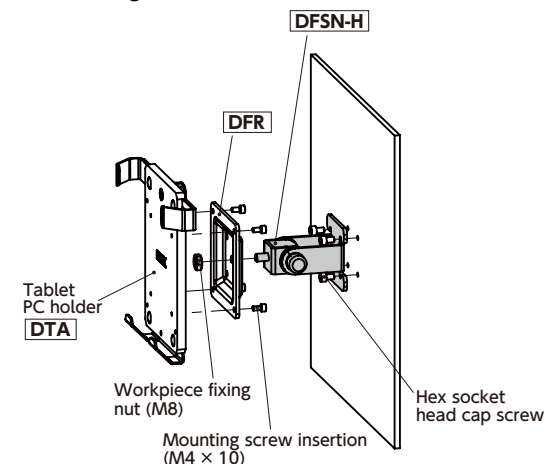

## Precautions for Use

- Even when the angle retention nut is in a loosened state, a certain specified torque (0.1N·m or higher) is necessary for angle adjustment. When performing angle adjustment, be careful to avoid applying an excessive load to the load item.
- Do not try to forcibly adjust the angle when the angle retention nut is in a tightened state. This will wear down the retention part, reducing its retention force.

## Relationship between angle retention nut tightening torque and retention torque

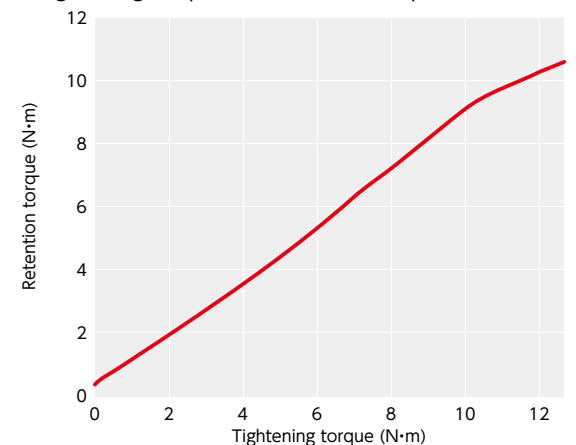

- The retention torques are test values. They are not guaranteed values.

## Part number specification

**DFS-N-H-60-M8-A**

1