

EAT-22
EAT-27
EAT-33

EAT-44

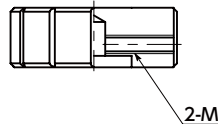
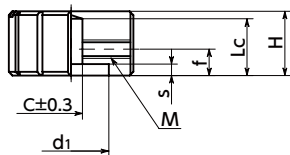
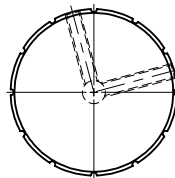
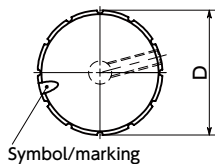

- **EAT-22** **EAT-27** **EAT-33** has symbol marks.

- Material/Finish



	EAT
Main body	Aluminum Alloy Anodized

Unit : mm

Part Number	D	H	d1	s	f	M (Coarse)		Lc	C	Mass (g)
						Nominal of Thread	Pitch			
EAT-22	22	15	16	3	5	1 - M4	0.7	13	6.1	12
EAT-27	26.5	17	20	3	6	1 - M4	0.7	15	6.1	22
EAT-33	33	17	20	3	7	1 - M4	0.7	15	6.1	33
EAT-44	44	16	20	3	6	2 - M4	0.7	12	6.1	58

- Hex socket set screw is provided.

- Part number specification

EAT-22



Cleanroom Wash & Packaging → P.xxxx	Screw Combination → P.xxxx	Screw Length Adjustment → P.xxxx	Vibration Resistant → P.xxxx	Laser Marking → P.xxxx
Available / Add'l charge	Not Available	Not Available	Not Available	Available / Add'l charge