

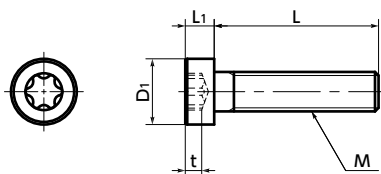

# SLT/SLTS Hexalobular Socket Head Cap Screws with Low Profile

**SUS** Stainless steel Protrusion



## ● Application

Reducing the size of equipment and devices

## ● Material/Finish



	SLT-TZB	SLTS
Main Body	SAE1022 Trivalent Chromate Treatment	SUSXM7 (Equivalent to SUS304)
Strength Class	8.8	A2-50



## ● Part number specification

**SLT - M5 - 20 - TZB**



- Hexalobular socket\*1 head cap screws with low head height.
- For space-saving of equipment/devices and applications with limited overhead space.
- Hexalobular socket shapes\*1 are designed to withstand high tightening torque. ➔ P.xxxx
- Install and remove with **SKX** Dedicated Wrench or **SKXB** Dedicated Bit and **SRD** Dedicated Magnetic Screwdriver together.
- Use the **SKX-N** hexalobular wrench for extremely limited access spaces for mounting and removing in tight spaces.

\*1: The hexalobular shape is prescribed by JIS B 1015: 2008(ISO 10664: 2005)"Hexalobular internal driving feature for bolts and screws".

SLT-TZB <small>Steel - Trivalent Chromate Treatment</small>		SLTS <small>Stainless steel</small>	Common dimensions															Unit : mm		
Part Number	Part Number	M (Coarse)		L 										D1	L1	Applicable wrench	Hexalobular Socket No.	t	Mass (g)	Qty per pack
		Nominal of Thread 	Pitch																	
	SLTS-M2	M2	0.4	4	5	6	8	10						3.8	1.55	SKX-6	6	0.84	0.11 - 0.23	50
	SLTS-M2.5	M2.5	0.45	5	6	8	10	12						4.5	1.85	SKX-8	8	0.91	0.26 - 0.47	50
SLT-M3-TZB	SLTS-M3	M3	0.5			6	8	10	12	16				5.5	2.4	SKX-10	10	1.27	0.53 - 0.98	50
SLT-M4-TZB	SLTS-M4	M4	0.7			6	8	10	12	16	20			7	3.1	SKX-20	20	1.66	1.1 - 2.3	50
SLT-M5-TZB	SLTS-M5	M5	0.8				8	10	12	16	20	25		8.5	3.65	SKX-25	25	1.91	1.8 - 4.1	50
SLT-M6-TZB	SLTS-M6	M6	1				8	10	12	16	20	25	30	10	4.4	SKX-30	30	2.29	3.1 - 7.1	20

- When purchasing less volume than one full bag, a separate handling fee is charged. For details, see the Sold Separately Service.

## ● Related Products

**SKX** Hexalobular Wrench



**SKX-N** Hexalobular Wrench for Extremely Limited Access Spaces



**SKXB** Hexalobular Short Bit



**SRD** Magnet Screwdriver



Individual Sales ➔ P.xxxx  
 Cleanroom Wash & Packaging ➔ P.xxxx  
 Screw Length Adjustment ➔ P.xxxx  
 Vibration Resistant ➔ P.xxxx  
 Modification process for captive use ➔ P.xxxx  
 Available / Add'l charge   Available / Add'l charge   Available / Add'l charge   Available / Add'l charge   Please feel free to contact us