

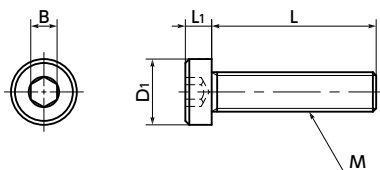

SPA-LC

Plastic screw - Hex Socket Low Head Bolt - RENY

Protrusion
 High strength



### ● Material/Finish



	SPA-LC
Main body	RENY*1 (Glass Fiber 50% Reinforced Polyamide MXD6) (Black)
Heat resistance temperature*2	105°C

\*1: RENY is a registered trademark of Mitsubishi Engineering-Plastics Corporation.

\*2: A value of plastic materials. The allowable operating temperature of the product varies depending on use conditions such as tightening torque.

- Hex socket head cap screw with low head.
- For space-saving of equipment/device and applications with a limited top space.
- RENY is thermoplastic engineering plastics with excellent tensile strength and bending strength.
- It is highly fatigue-resistant and has excellent creeping and heat insulation properties.
- While it is nearly as strong as metal, its weight is approximately 1/5 of iron.
- The properties and precautions of plastic screws  
→ P.xxxx

### ● Application

Heat insulation and dew condensation prevention of electric and electronic devices / refrigerating and freezing facilities / Weight saving of offshore instruments, plating facility and automobile, aircraft and space equipment, etc.

Unit : mm

Part Number	M (Coarse)		L								D1	L1	B	Tension*1 Rupture Load (N)	Torsional*1 Torque (N·m)	Mass (g)	Qty per pack	
	Nominal of Thread	Pitch																
SPA-M3-LC	M3	0.5	6	8	10	12	16	20			5.5	2	2	799	0.2	0.11 - 0.25	20	
SPA-M4-LC	M4	0.7	6	8	10	12	16	20	25		7	2.8	2.5	1286	0.74	0.24 - 0.58	20	
SPA-M5-LC	M5	0.8	6	8	10	12	16	20	25	30	8.5	3.5	3	1976	1.08	0.39 - 1	20	
SPA-M6-LC	M6	1			10	12	16	20	25	30	40	10	4	4	2767	2.26	0.75 - 2.1	20

\*1: Values in chart are for reference only. They are not guaranteed values. The recommendation torque is 50% of the torsional torque.

● When purchasing less volume than one full bag, a separate handling fee is charged. For details, see the Sold Separately Service.

### ● Part number specification

SPA-M5-30-LC

Product Code			Product Code
--------------	--	--	--------------

Individual Sales → P.xxxx	Cleanroom Wash & Packaging → P.xxxx	Screw Length Adjustment → P.xxxx	Vibration Resistant → P.xxxx	Modification process for captive use → P.xxxx
Available / Add'l charge	Available / Add'l charge	Not Available	Not Available	Not Available