

SNSI Hex Socket Head Cap Screws (Inconel equiv.)

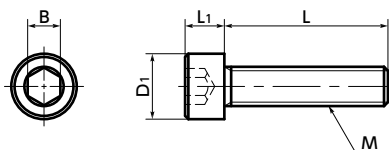

Cleanroom wash & packaging Heat-resistance Chemical-proof



● Mechanical property

	Inconel (NCF600)	SUS304
Tensile Strength (N/mm ²)	548 - 695	520 or Higher
0.2% Proof Stress (N/mm ²)	205 - 352	205 or Higher
Elongation (%)	35 - 55	40 or Higher
Hardness (HRB)	65 - 85	90 or Less

● Values in chart are for reference only. They are not guaranteed values.

● Physical property

	Inconel (UNS N06600)	SUS304
Specific Gravity	8.42	7.93
Longitudinal Elastic Modulus (GPa)	207	193
Specific Heat (J/kg·K)	444	500
Electric Resistance (μΩ·m)	1.0	0.7
Thermal Conductivity (W/(m·K))	16.7	17
Linear Expansion Coefficient (K ⁻¹)	13.4 x 10 ⁻⁶	17.3 x 10 ⁻⁶

● Values in chart are for reference only. They are not guaranteed values.

- Screws show excellent corrosion resistance against oxidizing and reducing by inorganic and organic acids. ➔ P.xxxx
- Excellent resistance to stress corrosion cracking caused by hydrogen sulfide ions.
- Nearly complete corrosion resistance against ammonia.
- Excellent heat resistance and creep resistance. High strength even near 600 deg C.

● Application

FPD production equipment, semiconductor devices, printed circuit board etching devices, metallic surface treatment equipment and facilities, and chemical plants

● Material/Finish



	SNSI
Main Body	UNS N06600 (Inconel®1600 equiv.)

*1: Inconel is a registered trademark of Special Metals Corporation.

Unit : mm

Part Number 1	M (Coarse)		L 2										D1	L1	B	Tension*1 Rupture Load (N)	Mass (g)
	Nominal of Thread	Pitch	6	8	10	12	16	20	25	30	35	40	5.5	7	8.5	10	13
SNSI-M3	M3	0.5											5.5	3	2.5	2750	0.77 - 1.5
SNSI-M4	M4	0.7											7	4	3	4810	1.8 - 3.4
SNSI-M5	M5	0.8											8.5	5	4	7780	2.9 - 5.2
SNSI-M6	M6	1											10	6	5	11000	5.5 - 9
SNSI-M8	M8	1.25											13	8	6	20000	13 - 21

*1: Values in chart are for reference only. They are not guaranteed values.

● Part number specification

SNSI-M5-16



Batch cleanroom packing is provided for orders containing multiple items of the same size.

Individual Sales ➔ P.xxxx	Cleanroom Wash & Packaging ➔ P.xxxx	Screw Length Adjustment ➔ P.xxxx	Vibration Resistant ➔ P.xxxx	Modification process for captive use ➔ P.xxxx
1 piece in 1 pack	Cleanroom washed and packed	Available / Add'l charge	Available / Add'l charge	Available / Add'l charge