

SNSTG Hex Socket Head Cap Screws - High Intensity Titanium Alloy



Cleanroom wash & packaging

Chemical-proof

Non-Magnetic

High strength

Lightweight

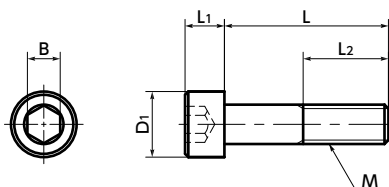

Material/Finish



	SNSTG
Main Body	Ti-6Al-4V (64 Titanium)

Physical Properties

	Ti-6Al-4V (64 Titanium)
Specific Gravity	4.43
Melting Point (°C)	1540
Longitudinal Elastic Modulus (GPa)	113
Thermal Conductivity (W/(m·K))	7.5
Linear Expansion Coefficient (K ⁻¹)	8.8×10 ⁻⁶
Electric Resistance (μΩ·m)	1.7
Amplitude Permeability (μ)	1.0002 (Nonmagnetic)

• Values in chart are for reference only. They are not guaranteed values.

Mechanical Properties



	Ti-6Al-4V (64 Titanium)
Tensile Strength (N/mm ²)	895 or Higher
0.2% Proof Stress (N/mm ²)	825 or Higher
Elongation (%)	10 or Higher

• Values in chart are for reference only. They are not guaranteed values.

- Made of high-strength titanium alloy.
- The specific gravity is approximately 60% that of stainless steel.
- Non-magnetic.
- Resistant to corrosion and with especially good seawater resistance.
- Special chemical polishing and brightening treatment improve the quality of the surface. Additionally, products have been cleanroom washed and packed. Cleanroom specification prevents oil and dirt from adhering.
- For the properties of titanium materials, see "Properties of Titanium."
- Application

Lightweight applications in automobiles, aircrafts, spacecrafts, and robots
FPD production equipment, semiconductor devices, electrical and electronic equipment, and aquatic applications

Unit : mm

Part Number 	M (Coarse)		L 												D ₁	L ₁	B	L ₂ *1	Tension Rupture Load *2 (N)	Mass (g)		
	Nominal of Thread	Pitch																				
SNSTG-M2	M2	0.4	4	5	6	8										3.8	2	1.5	Full Thread	1850	0.1 - 0.14	
SNSTG-M2.5	M2.5	0.45	4	5	6	8	10									4.5	2.5	2	Full Thread	3030	0.19 - 0.29	
SNSTG-M3	M3	0.5			6	8	10	12	16	20						5.5	3	2.5	Full Thread	5240	0.4 - 0.77	
SNSTG-M4	M4	0.7				8	10	12	16	20	25	30				7	4	3	Full Thread	8850	0.94 - 2.1	
SNSTG-M5	M5	0.8					10	12	16	20	25	30	35			8.5	5	4	Full Thread	14700	1.5 - 3.6	
SNSTG-M6	M6	1					10	12	16	20	25	30	35	40	45	50	10	6	5	45(L=50)	20800	2.7 - 7.5
SNSTG-M8	M8	1.25							16	20	25	30	35	40	45	50	13	8	6	45(L=50)	33700	6.9 - 14
SNSTG-M10	M10	1.5							16	20	25	30	35	40	45	50	16	10	8	45(L=50)	58900	12 - 22

*1 : If the "L" value is not in parentheses, the screw is full thread.

*2 : Values in chart are for reference only. They are not guaranteed values.

Part number specification

SNSTG-M5-20

1

2

Batch cleanroom packing is provided for orders containing multiple items of the same size.

Individual Sales	Cleanroom Wash & Packaging	Screw Length Adjustment	Vibration Resistant	Modification process for captive use
1 piece in 1 pack	Cleanroom washed and packed	Available / Add'l charge	Available / Add'l charge	Available / Add'l charge